

CONSTRUCTION
UNITS: 216 (173 parking required)
 PARKING: UNDERCROFT = 86
 BASEMENT = 81
 SURFACE = 79
 TOTAL = 246
 SURPLUS (BLOCK E) = 40

RATIO: 0.8

DECANT SECURE : 74 UNITS DEMOLISHED : 164 UNITS REMAIN : 433

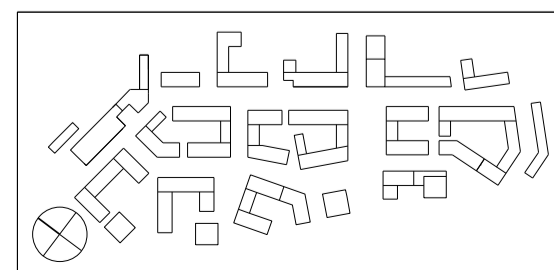

Do not scale from this drawing. Use figured dimensions only. Figured dimensions are in millimetres. All levels are in metres. All dimensions and levels shall be verified on site before proceeding with works. Detailed site survey to be carried out to verify positions and level relationships with site features and ordinance survey. The architect must be notified of any discrepancy. Where building components are described in the specification as contractor designed, "construction" information relating to those components on this drawing represents design intent only.

LEGEND

	Existing Sewer Line		Catalyst Site
	Ss11 No Build Zone		Phasing Boundary
	Planning Application Line		Affordable Units
	Hoarding Line		Units to be demolished following decant

REV	DATE	DESCRIPTION	OXD	REV	DATE	DESCRIPTION	OXD
P1	15.02.2013	Planning Application Issue	MC				

Allies and Morrison
 85 Southwark Street
 London SE1 0HK
 020 7921 0100
 020 7921 0101
 info@alliesandmorrison.co.uk
 telephone
 facsimile
 email
 A&M JOB NO: 716

WEST HENDON MASTERPLAN
SITE PLAN
PHASE 3A
716_00_07_020
 SCALE: 1:1000 @A1 1:2000 @A3